



A1
FIRE RATED



WATER
RESISTANT



STS 22mm FloorBoards

A defense against **Fire and Water**

BUILDING BETTER



STS / Building Better

A1
FIRE RATED



WATER
RESISTANT



TONGUE
& GROOVE



FIX DIRECT
TO JOIST



WEATHER
PROOF



Professionals choose **STS 22mm FloorBoards** for speed of fixing and peace of mind

A1 Fire Rated

STS 22mm FloorBoards are the only boards you need for fire protection. They replace multiple boards and reduce fixing time.

Water Resistant

Use STS 22mm FloorBoards for internal and external projects. These are boards that the weather can't damage on site, providing you a flexible building schedule.

No Squeaks

Denser than chipboard, STS 22mm FloorBoards are robust and with tongue and groove edges, are less likely to generate squeaks and customer callbacks.

Easy to handle

STS 22mm FloorBoards are available in 2400mm x 500mm sheets. Boards should always be carried on their edge to avoid unnecessary strain during handling.

Quick to fix

Fix STS 22mm FloorBoards direct to joists using STS Mega Strength adhesive and 50mm floor screws. Cutting boards is easy with reduced dust using an STS PCD saw blade.



STS 22mm FloorBoard Installation

1. Cut boards to size

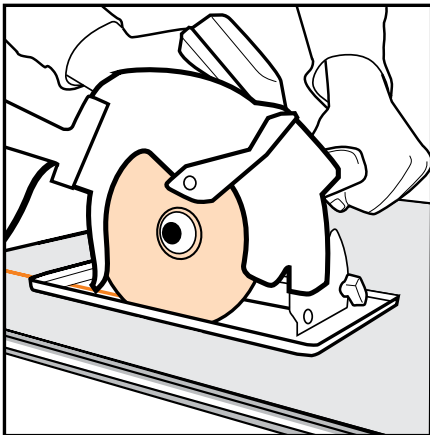

2. Stick board to joists

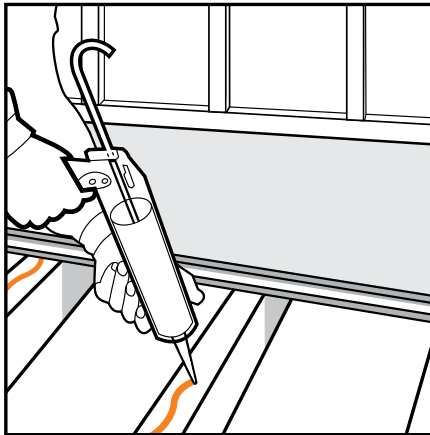

3. Screw board to joists

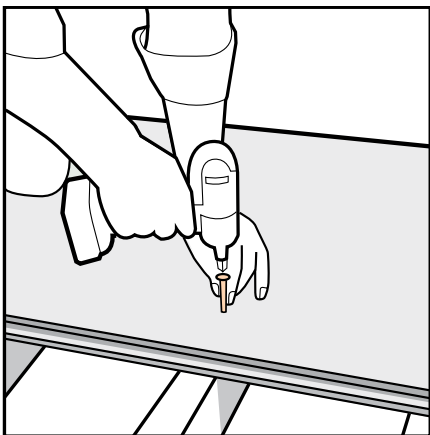

4. Seal between boards

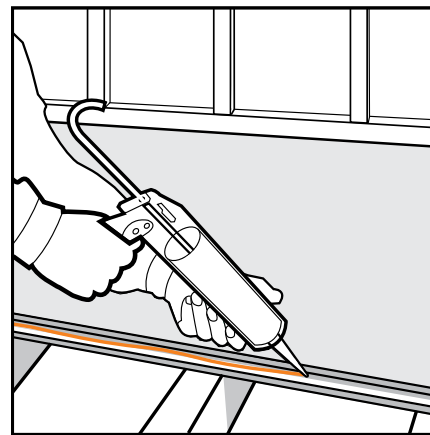

STS 22mm FloorBoards

Cut STS 22mm FloorBoards using a circular saw fixed with vacuum extractor and an STS PCD saw blade. This method will cut boards easily and mitigate dust.

STS 22mm FloorBoards can be fixed to timber or steel joists installed at maximum 600mm centres.

To achieve an acceptable finish, it is important that floor joists are level.

Apply a bead of STS Mega Strength adhesive to the joist, then position the first floor board.

Secure with 12 x 50mm STS floor screws, placed a minimum of 12mm from the square edge and 5mm from the side of the joist.

Ensure screws are placed a minimum distance of 25mm from the tongue and groove edge.

STS 22mm FloorBoards should be laid out in a brick bond pattern. All short, square edges should be fully supported.

Secure subsequent 22mm FloorBoards by applying MegaStrength along the length of the board's groove, before inserting the tongue of the next board.

Clean off any surplus adhesive with a damp cloth.

STS 22mm FloorBoards are ready to tile or install other surface finish immediately.



Cut it

Stick it

Screw it

22mm Technical Data (22mm x 500mm x 2400mm)

General information

Code and trade name: 5616 STS 22mm x 500mm x 2400mm

Description: The 22mm STS Tongue and Groove panels are used for installing floor substrates on metal or timber structures. They can safely resist the efforts generated by temporary and permanent loads. Any type of floor can be installed on them. They have tongue and groove joint edges that guarantee the mechanical joint between panels.

Product components

Portland cement, calcium carbonate, cellulose fibers, and other minor aggregates. The panels fulfill the requirements of resistance, safety, and durability required in the construction of buildings, as well as the most stringent environmental regulations. The STS panels are treated with a water-repellent that keeps permeability to water vapor.

Manufacture and Quality Control

STS panels are manufactured at facilities certified with the ISO 9001:2008, ISO 14001:2004, and OHSAS 18001:2009 standards. The STS panels are Type A, Grade I according to the ASTM C 1186-08 (2012) standard and Category A Class 1 Level 1 according to the INTE/ISO 8336:2011

Other Features

Weight (kg/unit)	31.6
Covering per unit (m ²)	1.2

Technical Specifications

Description	Minimum Value	Minimum Value
Flexural strength - dry (N/mm ²) ISO 8336	7.0	4.0
Elastic module - dry (kN/mm ²) ISO 8336	2.5	1.2
Density (kg/dm ³) ISO 8336	1.0	10.0
Moisture (%) ISO 8336		40
Total absorption (%) ISO 8336		25
Superficial absorption (%) ISO 8336		1.3
Moisture movement (mm/m) ISO 8336		4.0
Total contraction (mm/m) Own procedure		3.0
Water absorption Karsten (ml/24h) Exposed side Own procedure		
Smoke development (ASTM E - 84)		0
Flame spread (ASTM E - 84)		0

Nominal Dimensions

Dimension	Measurement	Tolerance
Thickness	22mm	± 0.6 mm
Width	500mm	± 1.0 mm
Length	2400mm	± 2.0 mm
Diagonal	2452mm	± 2.0 mm

Advantages

- Can be cut, sanded, nailed, drilled, and screwed with conventional tools
- Provide insulation to noise and heat
- Accept any type of finishing
- Moisture resistant
- Fungi resistant
- Fire resistant

0113 202 2010
sales@sts-uk.com
 visit: sts-uk.com

STS